

# **REZBA PARAMETRI VA TURLARI ULARNI CHIZMADA TASVIRLASH**

**Urishev Adhamjon Ergashaliyevich**

2011 yilgacha rezbali birikmalar, g'ildirak va tishli uzatma singari insoniyatning tabiatda uchramaydigan buyuk ixtirolaridan xisoblanardi. Biroq Karlsruhe texnologiya institutidagi bir guruh olimlarning "Science" jurnalidagi uzunburun qo'ng'izlarning Yangi Gvineyada yashovchi trigonopterus oblongus turi xaqidagi maqolasida, ularning oyoqlari tanasiga aylangich (vertluga) vositasida birikishi to'g'risida yozishdi. Aylangichning yuzasida konussimon vintni eslatuvchi qismi bo'lib, u qo'ng'iz koksi (qo'ng'izlardagi tos suyak analogi)dagi rezbali o'yiqa joylashadi. Bunday birikma yog'ochda yashovchi qo'ng'izga yuqori barqarorlik beradi.

Yintni eramizdan avvalgi VI-V asrlarda yashagan Arxit Tarentskiy kashf qilgan deb hisoblanadi. Arximed yasagan vint hammamiga maktab kursidan tanish.

**Demak bugungi darsimizda rezbalar,  
ularning tuzilishi borasida gaplashamiz.**

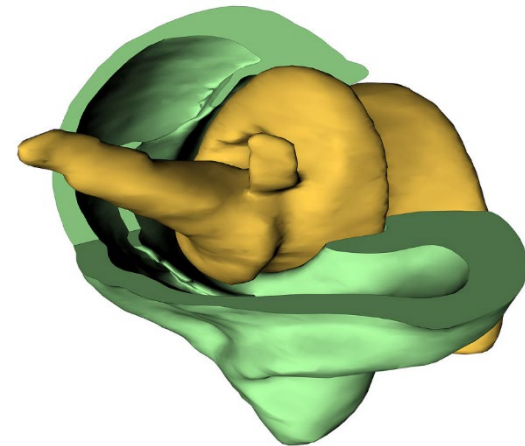

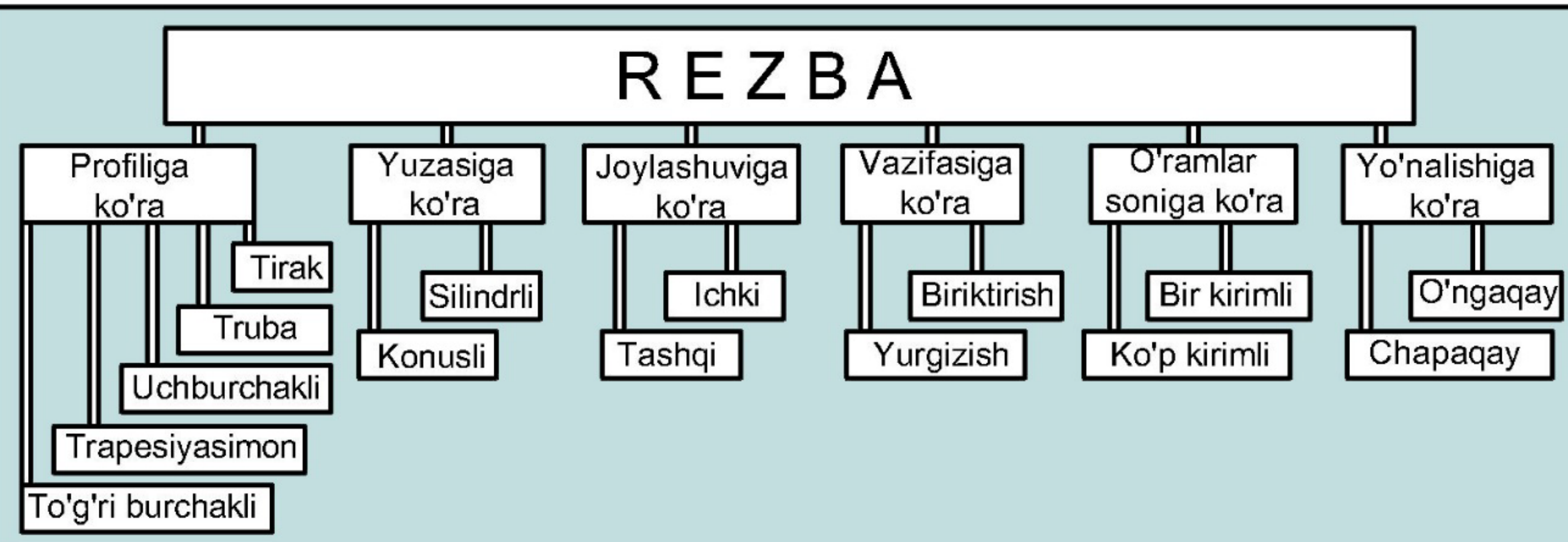

Yassi konturning vintli harakati natijasida hosil bo'lgan sirtga rezba deyiladi

Rezba bu — ma'lum bir sirdagi vintli chiziq bo'ylab qirqlgan ariqcha.

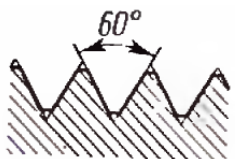
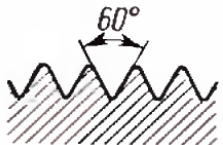
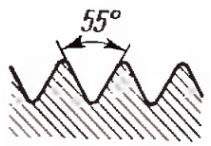
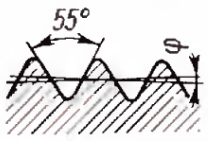
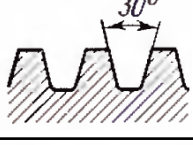

# Rezbalarni belgilashning umumiy sxemasi

Profili	Turi	Belgilanishdagi tartib						Dopusk maydoni yoki aniqlik sinfi
		Harfli belgisi	Tashqi diametri (mm) yoki dyumli belgisi	X belgisi	Qadami	O'ram yo'nali shi	— tire	
	Metrik	M	12				—	8g
		M	30			LH	—	7H
	Metrik (mayda qadam)	M	12	X	0,75		—	7H
	Slindrli trubali	G	1½				—	A
	Konusli trubali	R	¾					
	Trapesiyali	Tr	32	X	6		—	8H
	Tirak	S	50	X	8	LH	—	6e

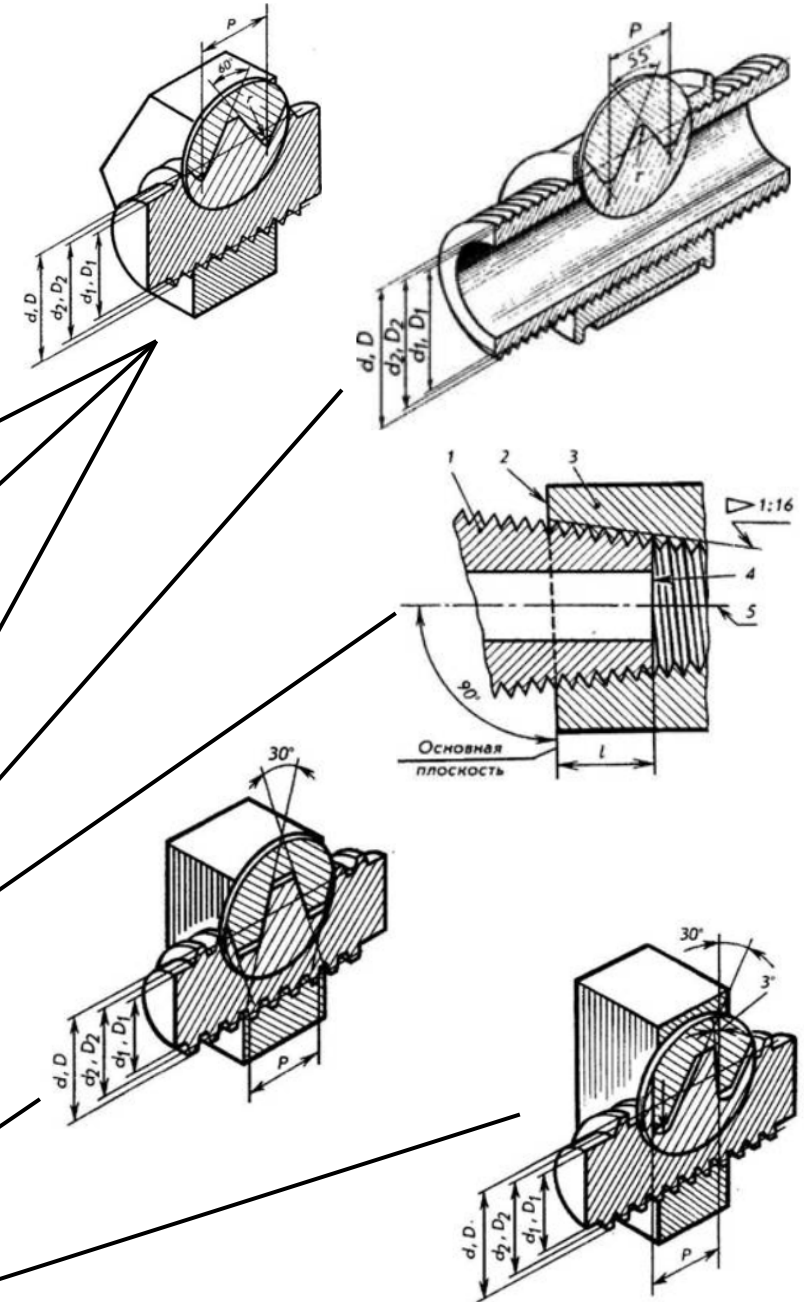

# REZBANING SHARTLI BELGILANISHI

Turi va standart №	Xarakteristikasi	Shartli belgisi	Chizmada ko'rsatiladigan o'lchami	Belgilanishiga namuna
Metrik GOST 8724-81	O'ngaqay	<b>M</b>	Tashqi diametri, mm	M12-6g (tashqi) M12-6g (ichki)
	Mayda qadam	<b>M</b>	Tashqi diametri, mm va qadami	M12x1-6g M12x1-6H
	Ko'p kirimli	<b>M</b>	Tashqi diametri, mm, yurish uzunligi, qadam belgisi (P) va qadami	M12x3(P1)-6g
	Chapaqay	<b>M</b>	LH harfi qo'shiladi	M12x3(P1)LH-6g
Slindrik Trubali GOST6357-81 (CT CEV 1167-78)	Tashqi	<b>G</b>	Rezbaning shartli belgisi, dyuymi (" belgisi ko'rsatilmaydi) va o'rta diametrining aniqlik sinfi	G1½-A (aniq klass) G1½-B (o'rtacha klass)
	Chapaqay			G1½LH-B
Konus trubali GOST6211-81 (CT CEV 1159-78)	Tashqi	<b>R</b>	Rezbaning shartli belgisi, dyuymi (" belgisi ko'rsatilmaydi)	R¾
	Ichki	<b>R<sub>c</sub></b>		R <sub>c</sub> ¾
Okulyar GOST5359-77	Optik asboblar uchun	<b>OK</b>	Tashqi diametri, mm va qadami va GOST	OK12x1,5 GOST5359-77
Edison yumaloq GOST6042-83 (SEV 3151-81)	Metallar	<b>E</b>	Tashqi diametri, mm va qadami va GOST	E27 GOST6042-83
	Metalmaslar			E27/N GOST6042-83

National pipe thread (NPT) -ANSI standartiga ko'ra dyumli konusli truba rezbaning konusligi 1:16 ( $\phi=3^{\circ}34'48''$ ). Profilning yuqorisidagi burchak  $60^{\circ}$ , profilning nazariy balandligi  $H=0,866025P$

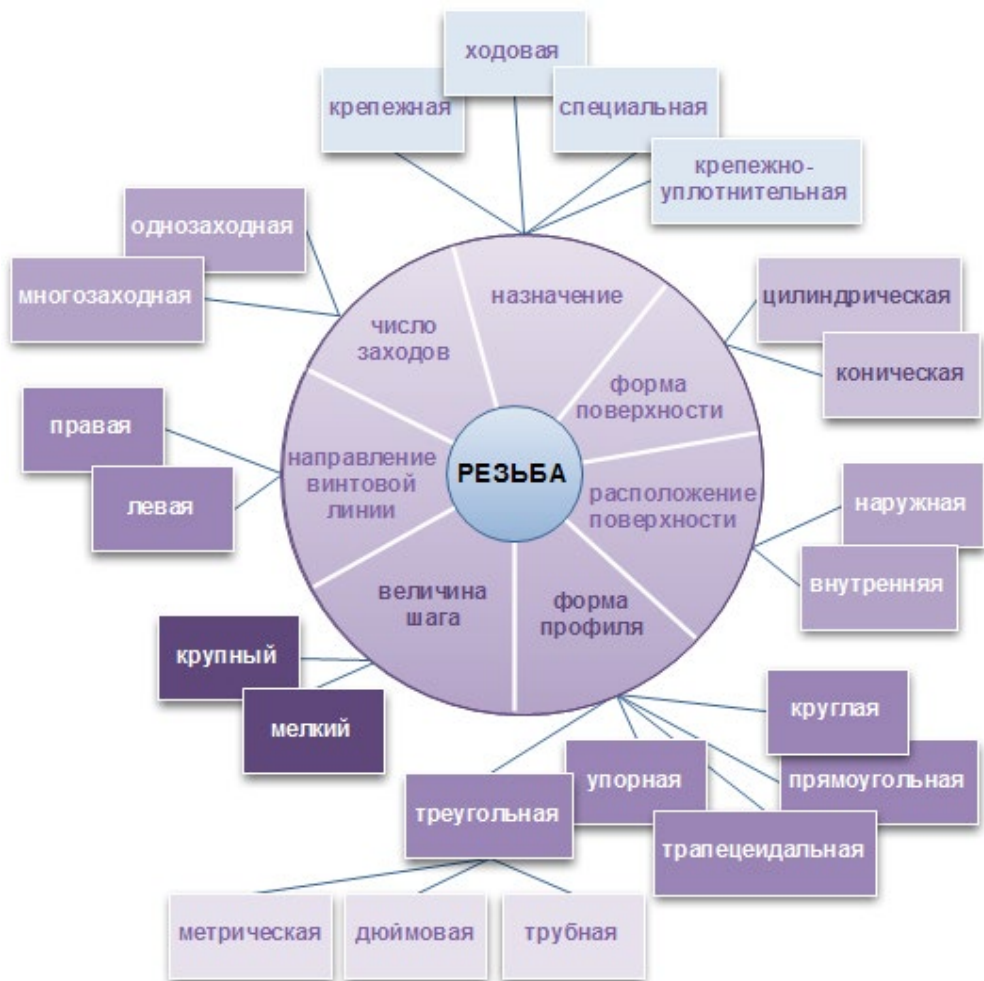

		Резьба метрическая (треугольная)
		Резьба трубная цилиндрическая
		Резьба трубная коническая
		Резьба дюймовая коническая
		Резьба круглая
		Резьба трапецидальная
		Резьба упорная
		Резьба прямоугольная нестандартная



# Sanoatda rezba yasash usullari

- Qirqish
- Abraziv qayta ishlash
- Yumalatish
- Ezib presslash
- Quyish
- Elektrofizik va elektroximik ishlov berish

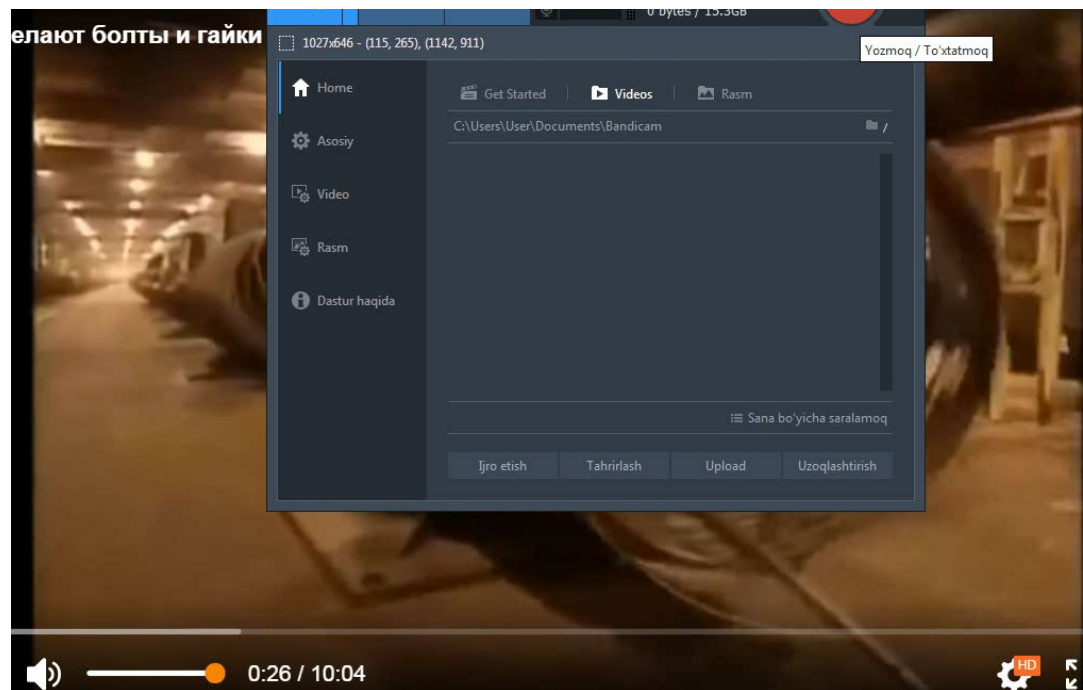

# O'yiqda va sterjenda rezba hosil qilish

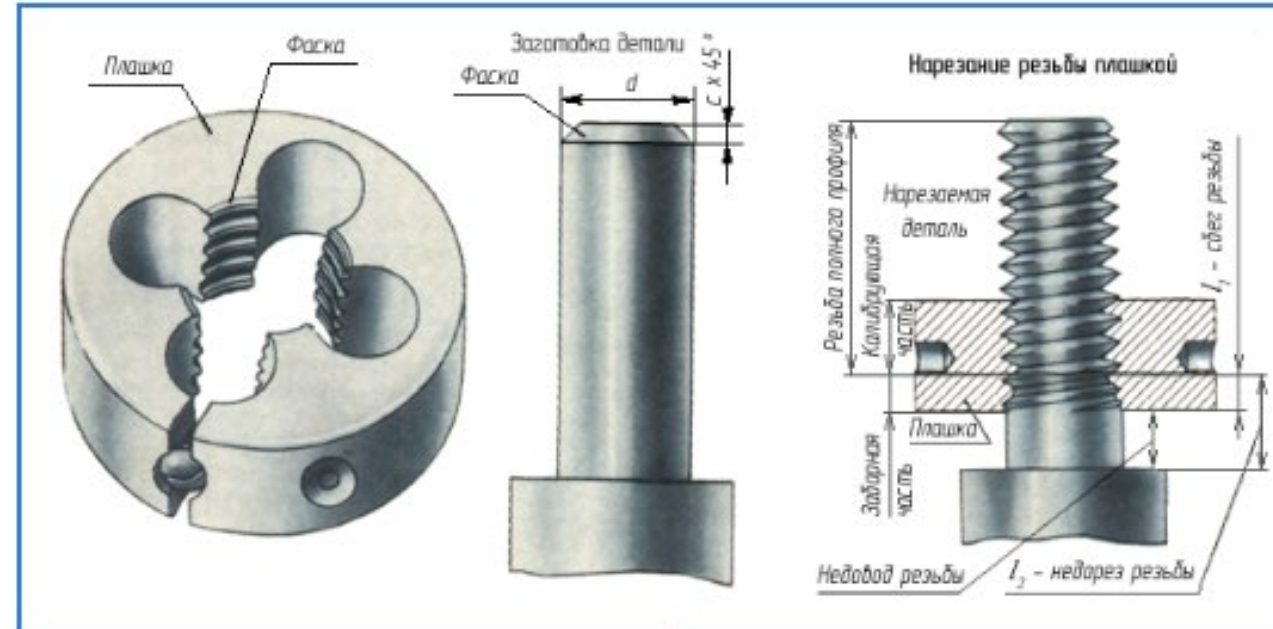
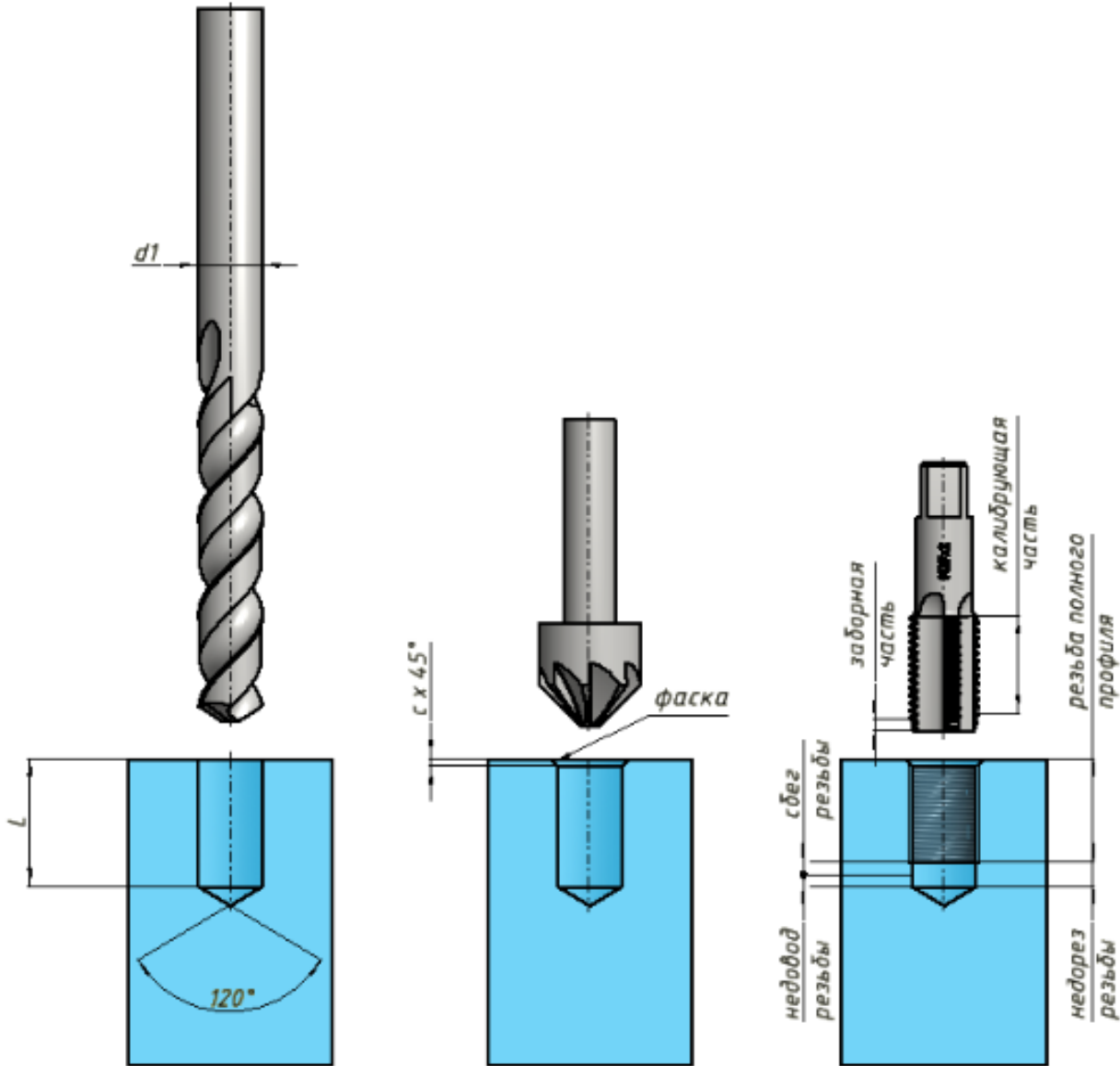



# Protochkaning tuzilishiga misol

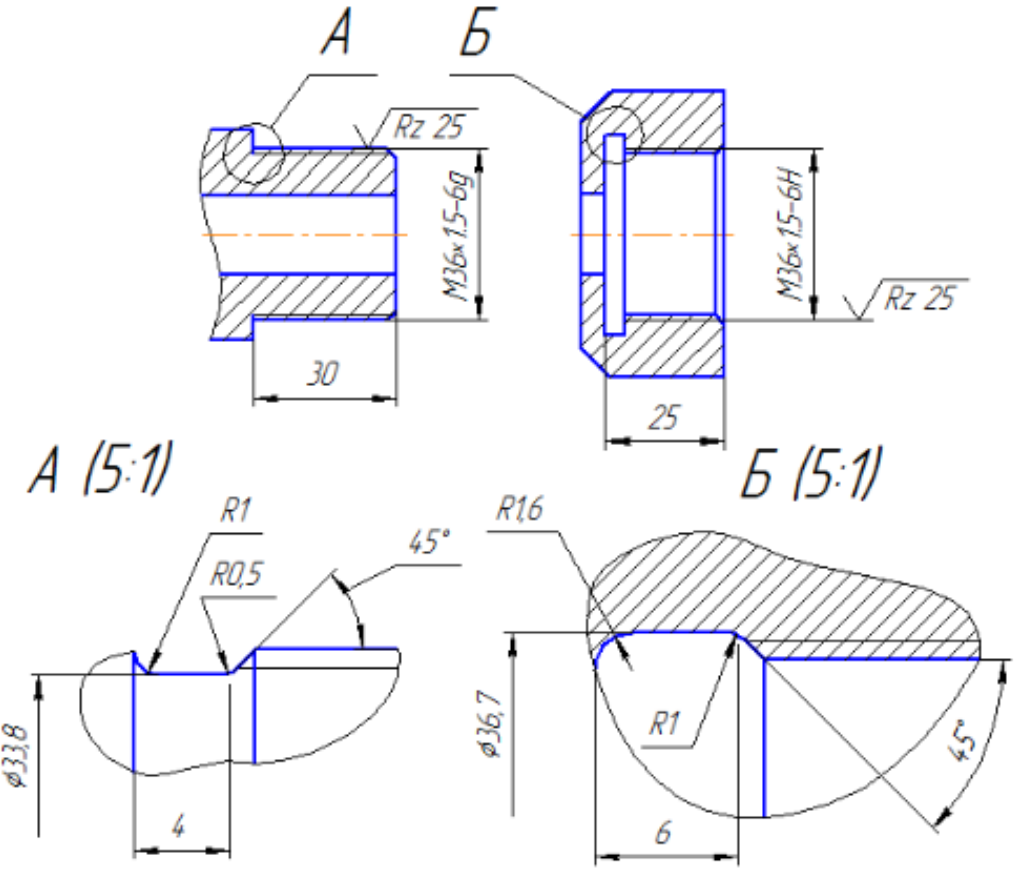

# Metrik rezbaning tuzilishi

Таблица 5.6 – Справочные данные о метрической цилиндрической резьбе ГОСТ 24705-2004

Diagram of a metric thread profile showing dimensions  $d$ ,  $d_2$ ,  $d_1$ ,  $h$ ,  $H$ ,  $S$ , and angles of  $60^\circ$ . The diagram labels the female thread as "Гайка" and the male thread as "Болт".

Диаметр резьбы			Шаг резьбы, s		Высота профиля, h
Наружный, d	Средний, d2	Внутренний, d1	Крупный	Мелкий	
1,0	0,838	0,730	0,25	–	0,135
	0,870	0,783	–	0,20	0,108
1,1	0,938	0,830	0,25	–	0,135
	0,970	0,883	–	0,20	0,108

# Standart biriktirish detaslarining shartli belgilanish tartibi

*Nimaligi* 2 M10x1,5-6gx80.109.30XGSA.09.6 GOST



Standart nomeri

Qoplamaning qalinligi mkm da

Qoplama turining belgisi

Po'lat yoki qotishma markasi

Mustahkamlik klassi yoi material gruppasi

Bolt, vint yoki shpilkaning uzunligi mm, da

Dopuski

Rezba qadami (mayda qadam uchun) mm da

Rezba turining belgilanishi va metrik rezbada diametri mm da

Bajarilishi (1-bajarilish ko'pincha ko'rsatilmaydi)

Biriktirish detalining nomi: bolt; gayka; vint; shpilka

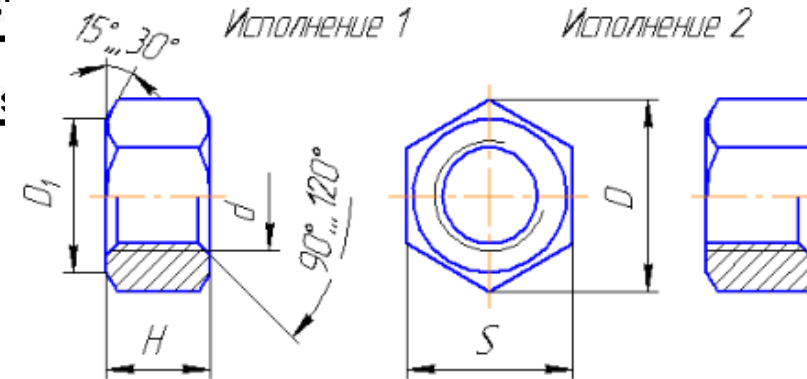

# Tashqi, ichki, trubali silindrik, va konusli rezbalarning ko'rsatilishi

